

**ORDINANCE NUMBER 40, 2025**

Tenth 2025 General Fund Budget Supplemental Appropriation of \$150,000 and Creation of a Line Item for East County EMS for Purchase of an Ambulance

**BE IT ENACTED** by the County Council of the County of Erie pursuant to Article II, Section 3B (1), 3B (2)(f) and Article VIII, Section 8 of the Home Rule Charter, and certified by the County Executive, that the creation of a line item and supplemental appropriation of \$150,000 from the 2025 General Fund Budget for East County EMS to purchase an ambulance through the Erie County Fire/EMS Transformational Grant is hereby approved as outlined on the attached Exhibit A.

This Ordinance shall be effective immediately upon adoption.

I, Karen Chillcott, hereby certify that on the motion of Schauerman, seconded by Bayle, this ordinance ~~was ENACTED AND ADOPTED~~ this 9th day of September, 2025 by a vote of 2 to 4. ~~\*\*FAILED~~

COUNTY COUNCIL OF THE  
COUNTY OF ERIE, PENNSYLVANIA

Attest:

Karen Chillcott  
Karen Chillcott  
County Clerk

Date: 9-9-25

VOTED NO  
Terry M. Scutella, Chair

VOTED NO  
Rock Copeland, Vice Chair

Charlie Bayle  
Charlie Bayle

Approved by:

VOTED NO  
Chris Drexel

Brenton Davis  
Brenton Davis,  
County Executive

VOTED NO  
André Horton

Date: \_\_\_\_\_

Ellen Schauerman  
Ellen Schauerman

ABSENT  
Jim Winarski

<b>Exhibit A</b> <b>2025 General Fund Budget</b> <b>Supplemental Appropriation of \$150,000</b> <b>For East County EMS Grant to Purchase an</b> <b>Ambulance</b>
--

<u>Account Title</u>	<u>Account Number</u>	<u>Amount</u>
<u>Total Revenue</u>		
Appropriation From Fund Balance	001-000990-099500	(150,000)
Total Revenue		<u>(150,000)</u>
<u>Total Expenditures</u>		
East County EMS	001-002710-006838*	150,000
Total Expenditures		<u>150,000</u>

\* Denotes creation of new line item.

ERIE COUNTY ORDINANCE RATIONALE REQUEST

To: County Council

From: Joseph Sinnott, Paul Lichtenwalter

Date to be placed on Finance Agenda: 9/4/2025

Subject: Supplemental Appropriation- East County EMS grant

\*\*Rationale summary should include the reason for ordinance request and the dollar amount.

**Rationale**

East County EMS was established in 2019 by the municipalities of Harborcreek, Lawrence Park and Wesleyville to provide first due Advance Life Services(ALS) to their residents. In 2025, the municipalities of Greenfield Township, North East Township and North East Borough designated East County as their first due provider for ALS. The addition of a larger coverage area and increased call volumes has made it necessary for East County to obtain a second ambulance. East County has received a grant commitment of \$100,000 from ECGRA, the total ambulance cost with new radio equipment installed is \$250,000. East County EMS has made application for a Erie County Fire/EMS Transformational grant for \$150,000.

The attached Exhibit A identifies the revenue and expenditures for this appropriation.

Department Name Finance

Date \_\_\_\_\_

Name(s) Attending Finance Meeting  
Paul Lichtenwalter



Many needs... no solution... Penn Care

**Penn Care: a regional supplier of EMS supplies, Medix ambulances, Fastlane Emergency Vehicles, Disaster Response Equipment, Ambulance Remounts/Refurbs and Service, with low prices, prompt delivery and knowledgeable product specialists we hope to become your one stop shop for all your EMS needs.**

**8/5/2025**

**East Erie County Emergency Services  
5601 Buffalo Rd.  
Harborcreek, PA 16421**

**2026 Type I Medix Rp90es, Chevy Ck3500 4x4 gas chassis**

Base Unit Price:	\$186,450.00
Additions: Stryker Cot/ Power Load	\$65,000.00
Graphics:	\$5,200.00
CoStars Discount: 1-3 trucks 5%	\$7,961.80

**Total Per Truck: \$242,688.20**

ALL COMPARTMENT/ENTRY DOORS TO HAVE POWER LOCKS WIRE TO OEM  
 ALL WARNING, SCENE, AND TAIL LIGHTS TO HAVE BLACK BEZELS FOR BLACKOUT PACKAGE  
 ALL GREEN DIMENSIONS ARE TAKEN FROM EDGE OF WALL  
 SURFACE PRIOR TO CORNER CAP BEING APPLIED

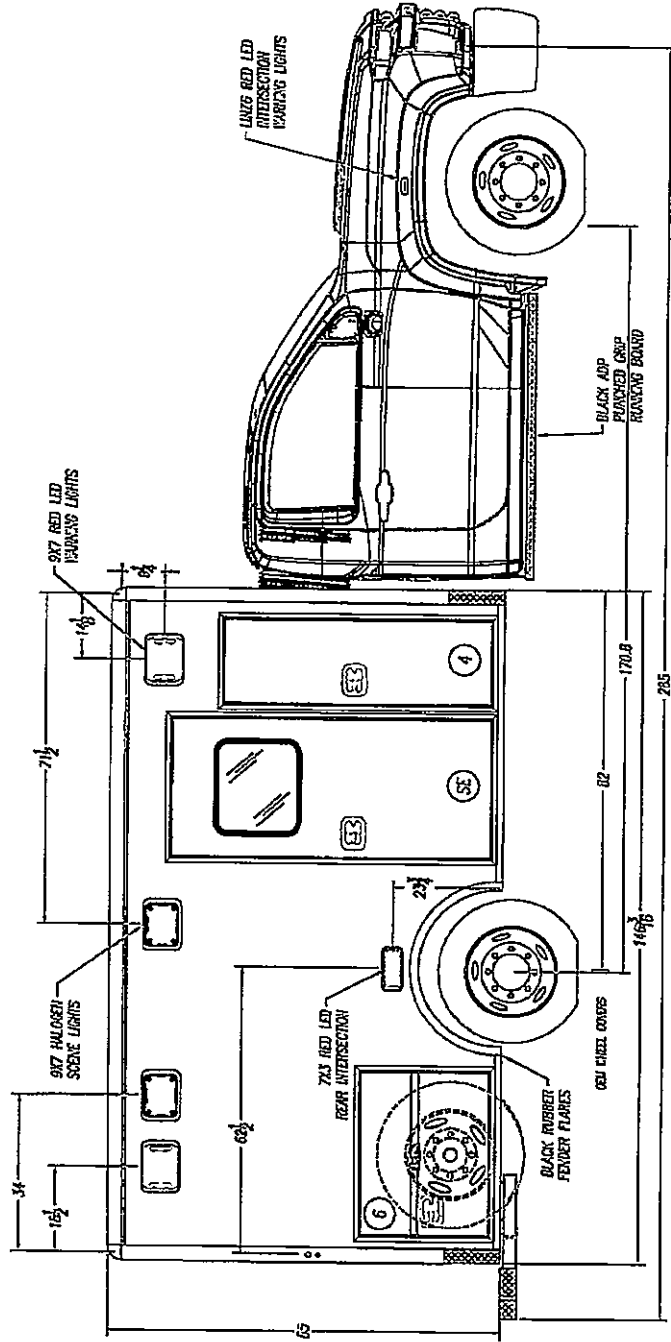

COMPARTMENT SIZES		NOTE: THE DIMENSIONS BELOW ARE OVERALL INTERIOR SIZES FOR EACH SPECIFIED COMPARTMENT TUB	
NO.	COMPARTMENT TYPE	WIDTH	HEIGHT
4	ALS/BATTERY COMPARTMENT	19 3/4"	15 1/2"
6	OPTIONAL SPARE TIRE COMPARTMENT	35 3/4"	28 3/4"
COMPARTMENT / ENTRY DOOR SIZES		WIDTH	HEIGHT
4	COMPARTMENT / ENTRY DOOR TYPE	18"	58 1/4"
6	ALS/BATTERY COMPARTMENT DOOR	35 3/4"	27 3/4"
SE	OPTIONAL SPARE TIRE COMPARTMENT DOOR	28 3/4"	68 1/4"
SE	SIDE ENTRY DOOR	28 3/4"	68 1/4"

COMPARTMENT & ENTRY DOORS		COMPARTMENT TUBS	
NO.	PART NUMBER	NO.	PART NUMBER
4	71-A10810	4	41-101372
6	71-118461	6	41-118457
SE	71-118128		

DESCRIPTION: CHEVY C/K 3500 - GAS - 171" W.B. 146" RP90 TYPE I AMBULANCE  
 CURE SIDE EXTERIOR

DRAWN BY: J. STANSBURY DATE CREATED: 3/28/2023 SCALE: 5/16" = 1"  
 REVISED BY: D. EDWARDS DATE REVISED: 5/24/2023 REVISION: B

3008 MOBILE DRIVE  
 ELKHART, IN 46314  
 PH: 574-266-0911  
 SPECIALTY VEHICLES, INC. FAX: 574-266-6669  
 "LET US SHOW YOU THE MEDIX DIFFERENCE"  
 WWW.MEDIXAMBULANCE.COM

Note: Drawings are for reference only, measurements may vary from actual product.

ALL COMPARTMENT/ENTRY DOORS TO HAVE POWER LOCKS WIRE TO OEM  
 ALL WARNING, SCENE, AND TAIL LIGHTS TO HAVE BLACK BEZELS FOR BLACKOUT PACKAGE  
 ALL GREEN DIMENSIONS ARE TAKEN FROM EDGE OF WALL  
 SURFACE PRIOR TO CORNER CAP BEING APPLIED

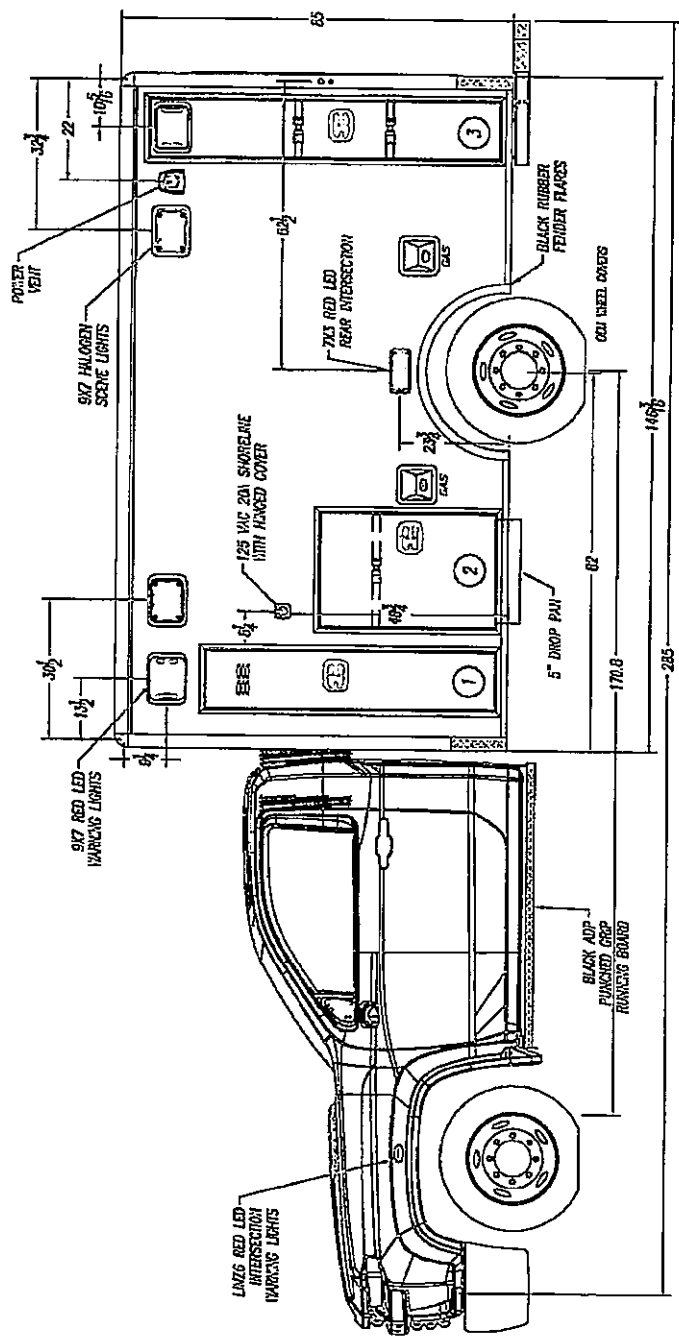

NOTE: THE DIMENSIONS BELOW ARE OVERALL INTERIOR SIZES FOR EACH SPECIFIED COMPARTMENT TUB

NO.	COMPARTMENT TYPE	WIDTH	HEIGHT	DEPTH
1	O2 COMPARTMENT	13 7/8"	63 7/8"	13 7/8"
2	AID STORAGE COMPARTMENT	25 7/8"	30 3/4"	13 5/8"
3	BACKBOARD STORAGE COMPARTMENT	13 5/8"	76 7/8"	17 1/2"

COMPARTMENT & ENTRY DOORS

NO.	PART NUMBER	NO.	PART NUMBER
1	71-A10801	-	-
2	71-A10802	-	-
3	71-A10804	-	-

CHEVY C/K 3500 - GAS - 171" W.B.  
 146" RP90 TYPE I AMBULANCE

DESCRIPTION: STREET SIDE EXTERIOR

DATE CHECKED: 5/28/2023 SCALE: 5/16"=1'  
 REVISION: 3  
 DATE REVISION: 5/24/2023 REVISION: B

Note: Drawings are for reference only, measurements may vary from actual product.

COMPARTMENT TUBS

NO.	PART NUMBER	NO.	PART NUMBER
1	41-101222	-	-
2	41-101223	-	-
3	41-103220	-	-

COMPARTMENT / ENTRY DOOR SIZES

NO.	COMPARTMENT / ENTRY DOOR TYPE	WIDTH	HEIGHT
1	O2 COMPARTMENT DOOR	12 3/4"	62 1/2"
2	AID STORAGE COMPARTMENT DOOR	24 3/8"	37 1/8"
3	BACKBOARD STORAGE COMPARTMENT DOOR	12 1/8"	75 1/2"

**MEDIX**  
 SPECIALTY VEHICLES, INC.  
 3008 MOBILE DRIVE  
 ELKHART, IN 46514  
 PH: 574-266-0911  
 FAX: 574-266-6669  
 "LET US SHOW YOU THE MEDIX DIFFERENCE"  
 WWW.MEDIXAMBULANCE.COM



Dealer: PENNCARE

Approved By:

Date:

Customer: WEST HILLS

22-RP1475

Sheet **D**

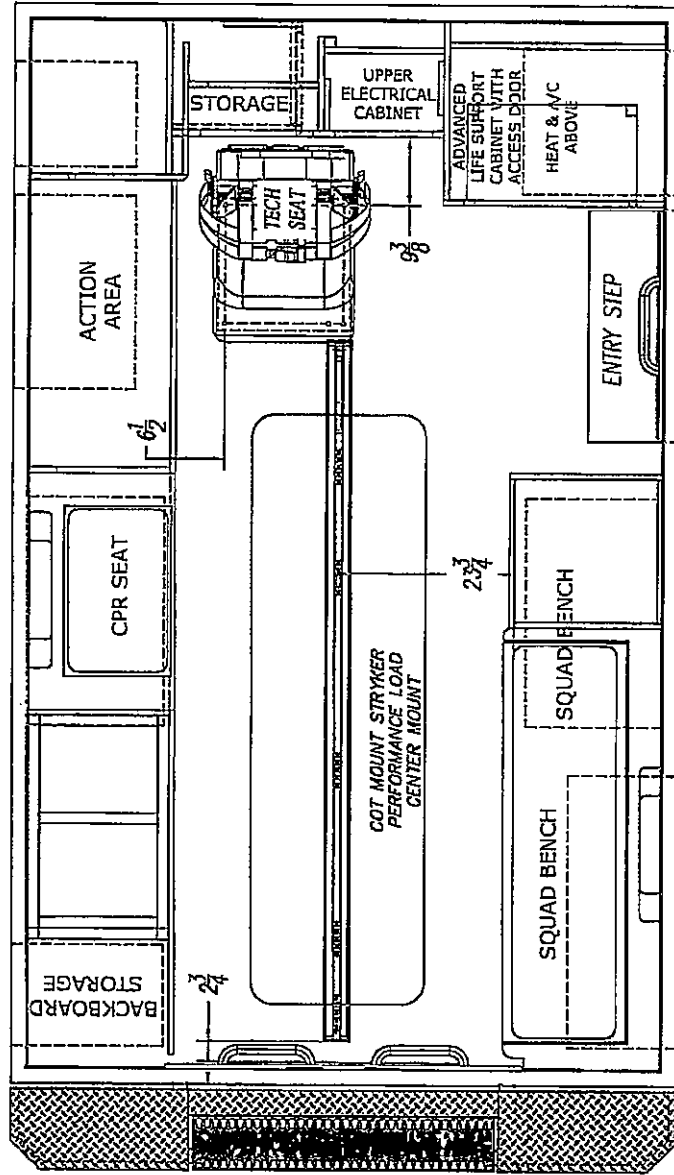

CHEVY C/K 3500 -GAS- 171" W.B.  
 146" RP90 TYPE I AMBULANCE

DESCRIPTION:	PATIENT AREA PLAN		
DRAWN BY:	DATE CREATED:	SCALE:	
I. STANSBURY	3/28/2023	1/2" = 1'	
REVISED BY:	DATE REVISION:	REVISION:	
D. EDWARDS	5/24/2023	B	

(Note: Drawings are for reference only, measurements may vary from actual product.)

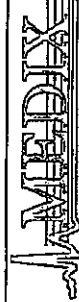

3008 MOBILE DRIVE  
 ELKHART, IN 46514  
 PH: 574-266-0911  
 SPECIALTY VEHICLES, INC. FAX: 574-266-6669

"LET US SHOW YOU THE MEDIX DIFFERENCE"  
 WWW.MEDIXAMBULANCE.COM

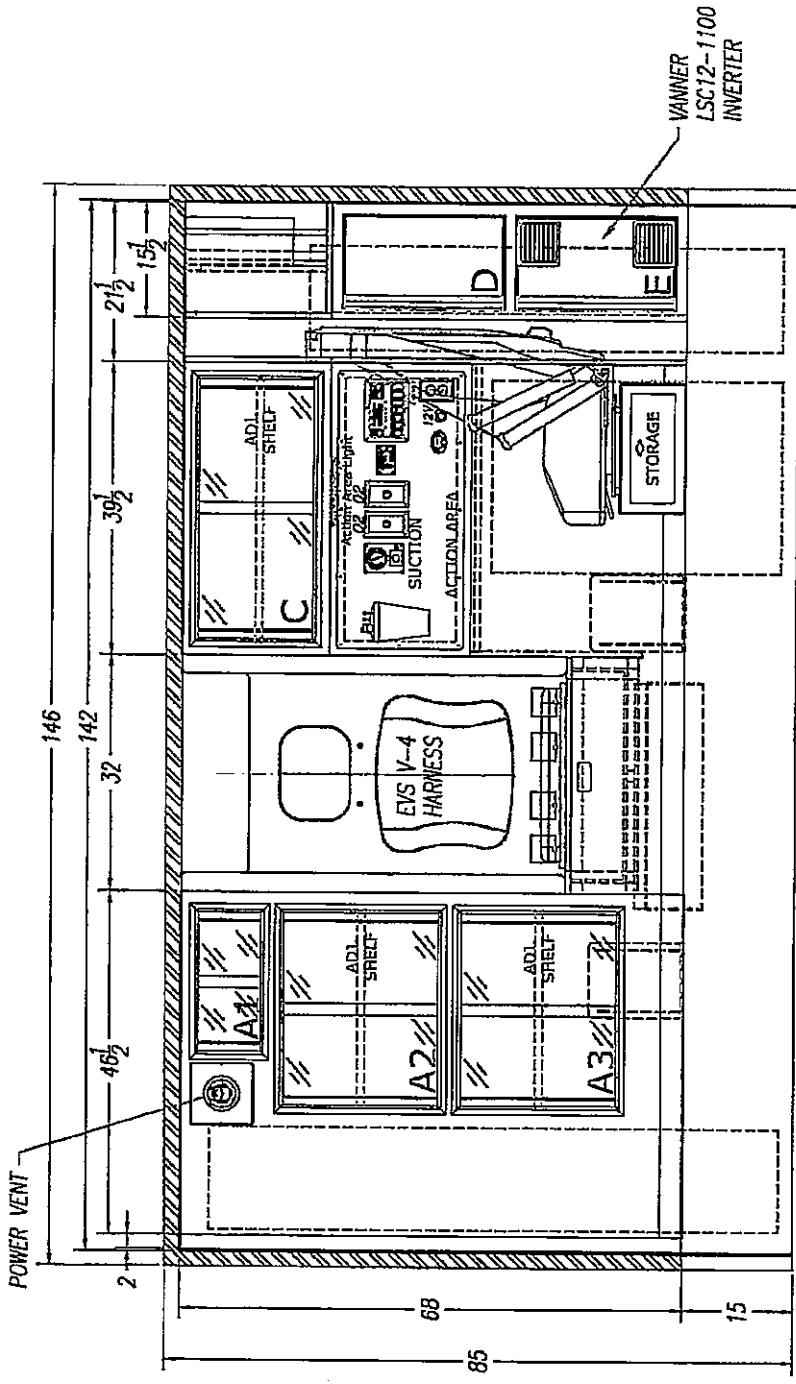

**MEDIX**  
 3008 MOBILE DRIVE  
 ELKHART, IN 46514  
 PH: 574-266-0911  
 SPECIALTY VEHICLES, INC. FAX: 574-266-6669  
 "LET US SHOW YOU THE MEDIX DIFFERENCE"  
 WWW.MEDIXAMBULANCE.COM

**CHEVY C/K 3500 -GAS- 171" W.B.**  
**146" RP90 TYPE 1 AMBULANCE**  
**DESCRIPTION:** STREET SIDE INTERIOR  
**DRAWN BY:** I STANSBURY **DATE CREATED:** 3/28/2023 **SCALE:** 1/2" = 1'  
**REVISED BY:** D. EDWARDS **DATE REVISION:** 5/24/2023 **REVISION:** B  
 Note: Drawings are for reference only, measurements may vary from actual product.

INTERIOR CABINET STORAGE			SPECIAL NOTE
ITEM	HEIGHT	WIDTH	DEPTH
A1	9 3/4"	19 3/4"	15"
A2/A3	21 3/4"	27"	15"
C	18 1/4"	35 3/4"	13"
D	21 3/4"	12 3/4"	16 3/4"
E	21 3/4"	12 1/2"	16 3/4"
F			

Dealer: PENNCARE

Approved By:

Date:

Customer: WEST HILLS

22-RP1475

Sheet

F

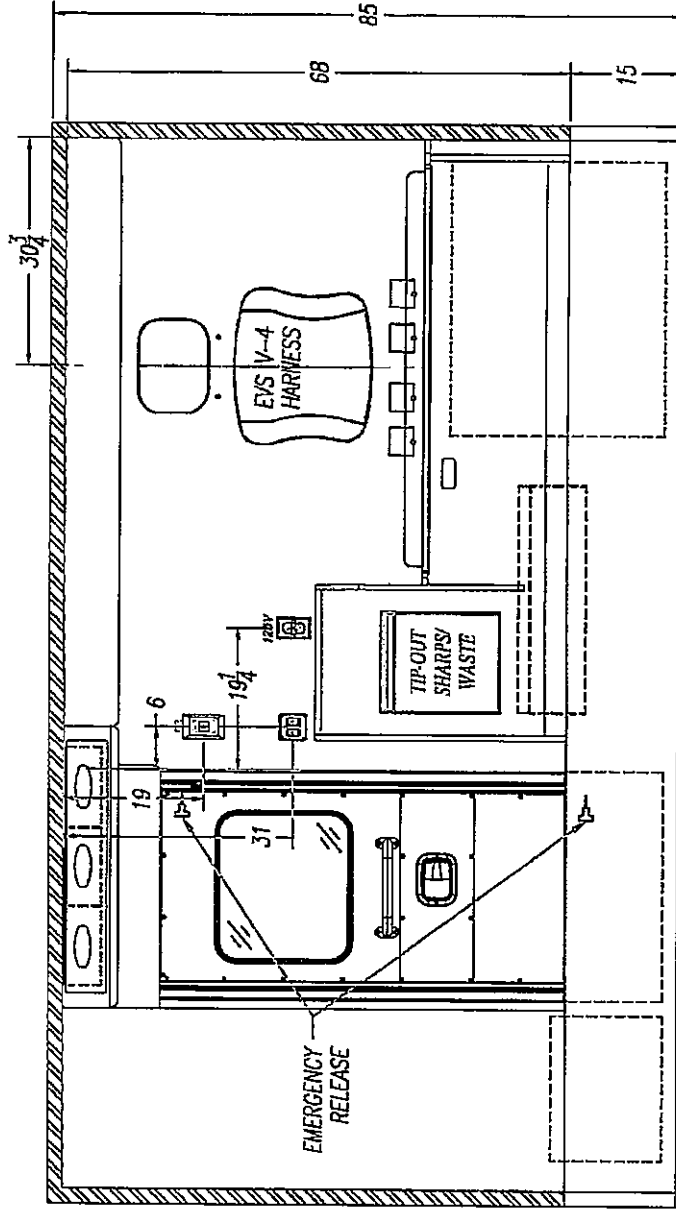

**4" SEATBELT  
PLATE LOCATION**

**WELD SHOP  
CABINET SHOP**

NOTE: READ THE  
DIMENSIONS FROM RIGHT  
TO LEFT AS VIEWED

**33 INCHES**

NOTE: THIS DIMENSION IS FROM THE BOTTOM OF THE WALL TO THE BOTTOM OF THE 4" PLATE.

**WELDED**

NOTE: THE HOLES FOR THE TOP SEATBELT BOLTS ARE 1 1/2" FROM THE TOP OF THE SQUAD BENCH TO THE CENTER OF THE SEATBELT BOLT.  
NOTE: THE HOLES FOR THE BOTTOM SEATBELT BOLTS ON THE SQUAD BENCH ARE 9 3/4" FROM THE TOP OF THE FLOOR TO THE CENTER OF THE BOLT.

**BOTTOM**

THE LOCATION OF THE BOTTOM SEATBELT HOLES ARE FROM THE REAR WALL TO THE CENTER OF THE 1/2" HOLE

**TOP**

THE LOCATION OF THE TOP SEATBELT HOLES ARE FROM THE REAR WALL TO THE CENTER OF THE 1/2" HOLE

**CHEVY C/K 3500 - GAS - 171" W.B.  
146" RP90 TYPE I AMBULANCE**

DESCRIPTION: CURB SIDE INTERIOR

DRAWN BY: J. STANSBURY DATE CREATED: 3/28/2023 SCALE: 1/2" = 1'

REVISED BY: D. EDWARDS DATE REVISION: 5/24/2023 REVISION: B

Notes: Drawings are for reference only, measurements may vary from actual product.



3008 MOBILE DRIVE  
ELKHART, IN 46514  
PH: 574-266-0911  
SPECIALTY VEHICLES, INC. FAX: 574-266-6669  
"LET US SHOW YOU THE MEDIX DIFFERENCE"  
WWW.MEDIXAMBULANCE.COM

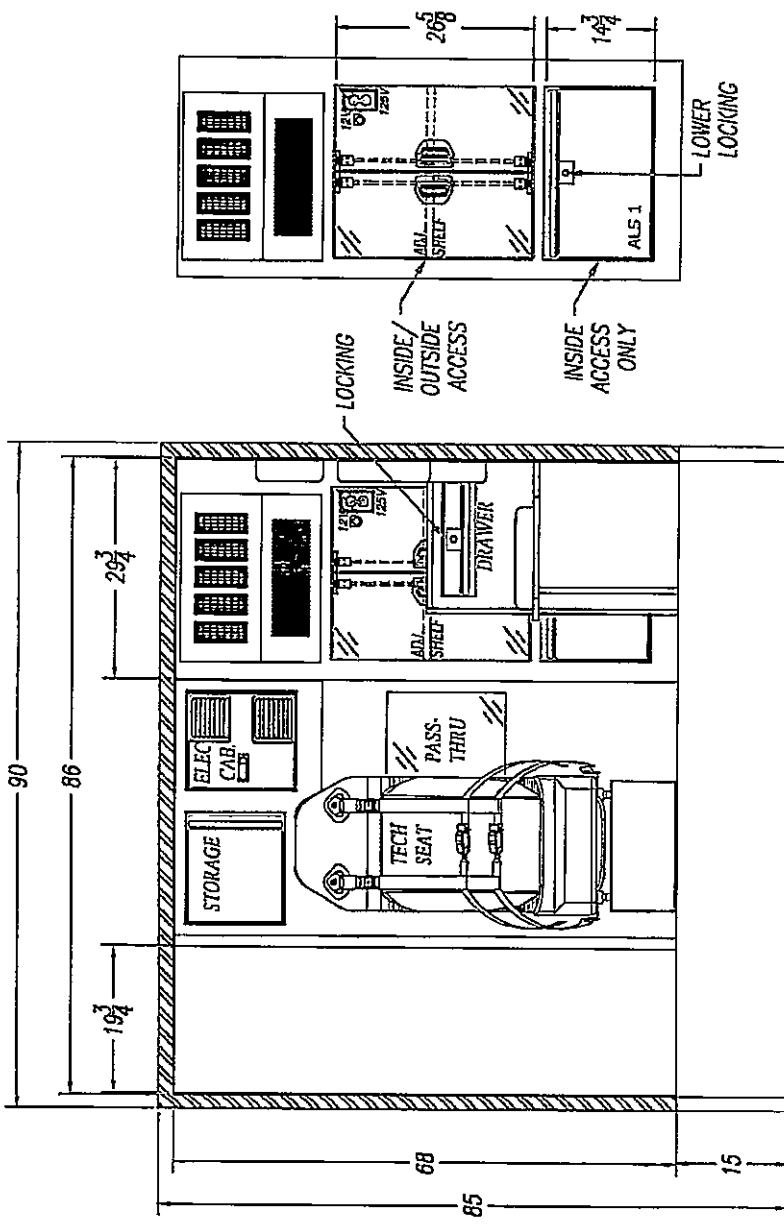

**MEDIX**  
 SPECIALTY VEHICLES, INC.      PH: 574-266-0911      FAX: 574-266-6669  
 "LET US SHOW YOU THE MEDIX DIFFERENCE"  
 WWW.MEDIXAMBULANCE.COM

**CHEVY C/K 3500 --GAS-- 171" W.B.**  
**146" RP90 TYPE I AMBULANCE**  
**FRONT ELEVATION**  
 DRAWN BY: J. STANSBURY      DATE: 3/26/2023      SCALE: 1/2" = 1'  
 REVISED BY: D. EDWARDS      DATE: 5/24/2023      REVISION: B  
 Note: Drawings are for reference only, measurements may vary from actual product.

INTERIOR CABINET STORAGE			
ITEM	HEIGHT	WIDTH	DEPTH
ALS-1	14 3/4"	30"	20 1/2"
ALS-2	28 3/4"	30"	20 1/2"
SPECIAL NOTE			

Dealer: PENNCARE

Approved By:

Date:

Customer: WEST HILLS

22-RP1475

Sheet H

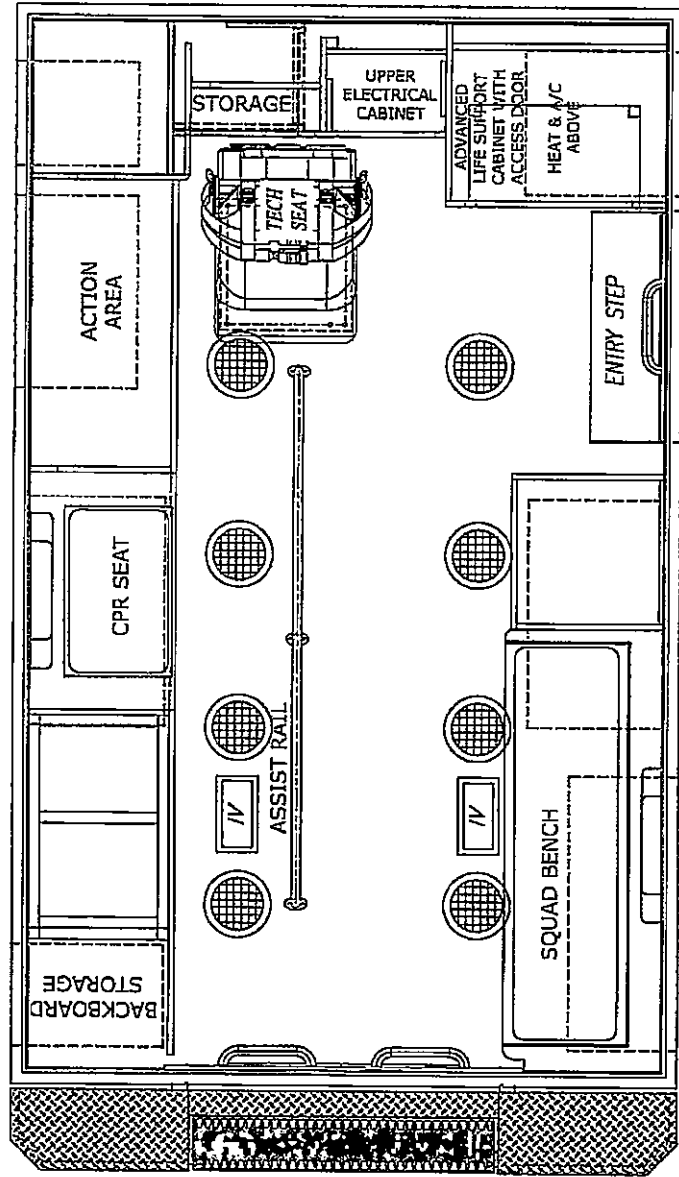

CHEVY C/K 3500 -GAS- 171" W.B.  
 146" RP90 TYPE I AMBULANCE

DESCRIPTION:

CEILING LAYOUT

DRAWN BY:	DATE CREATED:	SCALE:
I. STANSEBURY	3/28/2023	1/2"=1'
REVISED BY:	DATE REVISED:	REVISION:
D. EDWARDS	5/24/2023	B

Note: Drawings are for reference only, measurements may vary from actual product.

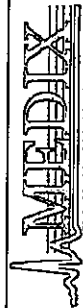

3008 MOBILE DRIVE  
 ELKHART, IN 46514  
 PH: 574-266-0911  
 SPECIALTY VEHICLES, INC. FAX: 574-266-6069  
 WWW.MEDIXAMBULANCE.COM

"LET US SHOW YOU THE MEDIX DIFFERENCE"

Dealer: PENNCARE

Approved By:

Date:

Customer: WEST HILLS

22-RP1475

SHEET

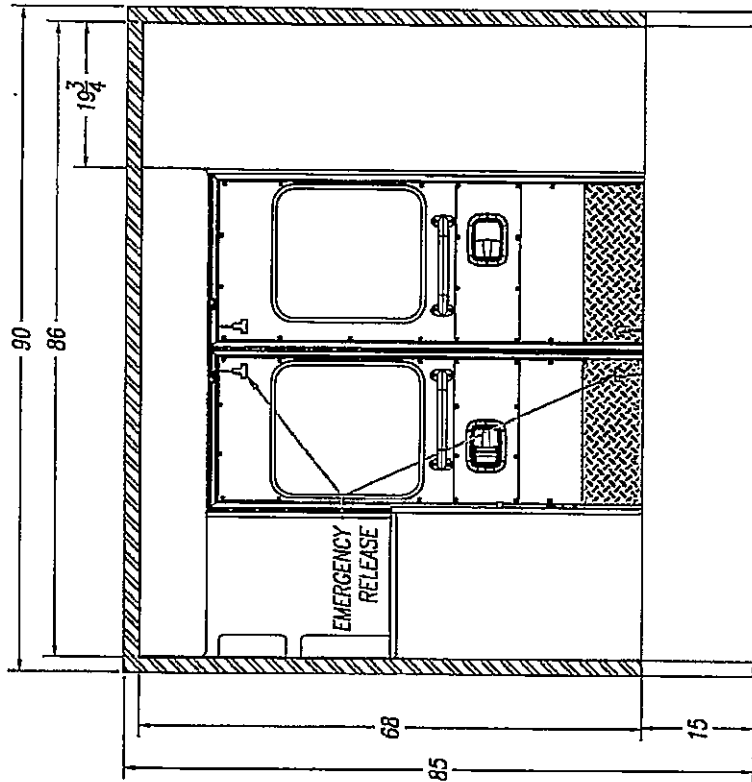

CHEVY C/K 3500 --GAS-- 171" W.B.  
 146" RP90 TYPE I AMBULANCE

DESCRIPTION:		REAR ELEVATION	
DRAWN BY:	DATE CREATED:	SCALE:	REVISION:
I. STANSBURY	3/28/2023	1/2" = 1"	
REVISED BY:	DATE REVISION:		
D. EDWARDS	5/24/2023		B

Note: Drawings are for reference only, measurements may vary from actual product.

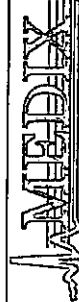

3008 MOBILE DRIVE  
 ELKHART, IN 46514  
 PH: 574-266-0911  
 SPECIALTY VEHICLES, INC. FAX: 574-266-6669

"LET US SHOW YOU THE MEDIX DIFFERENCE"  
 WWW.MEDIXAMBULANCE.COM

Dealer: PENNCARE

Approved By:

Date:

Customer: WEST HILLS

22-RP1475

Sheet

J

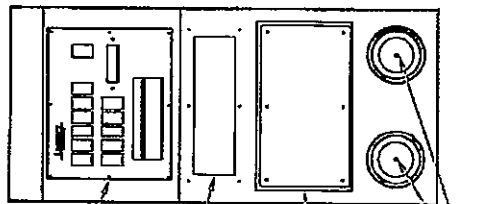
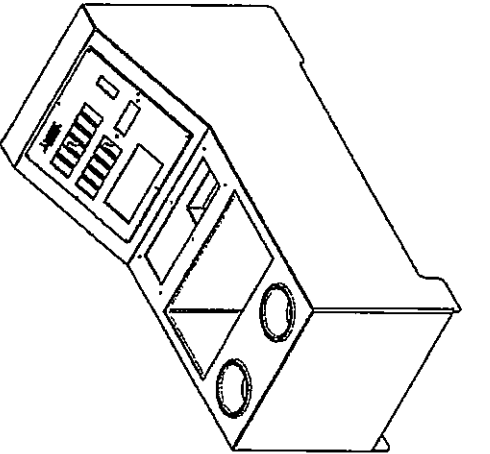

SWITCHPANEL

RADIO PANEL

STORAGE

(2) CUP HOLDERS

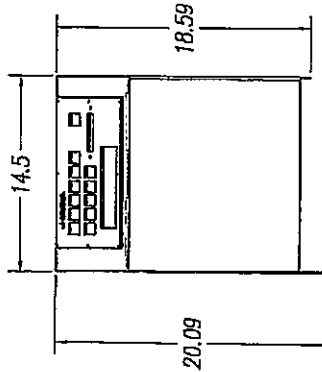

14.5

20.09

18.59

31.5

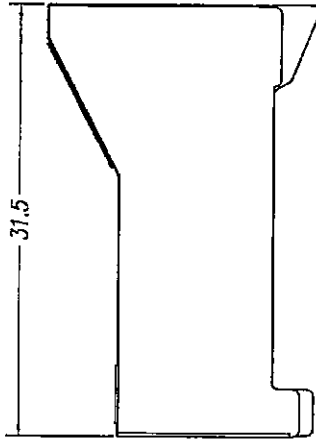

CHEVY C/K 3500 -GAS- 171" W.B.  
 146" RP90 TYPE I AMBULANCE

DESCRIPTION:

FRONT CONSOLE

DRAWN BY:	DATE CREATED:	SCALE:
I STANSBURY	3/28/2023	1/2"=1"
REVISED BY:	DATE REVISION:	REVISION:
D. EDWARDS	5/24/2023	B

(Notes: Drawings are for reference only, measurements may vary from actual product.)

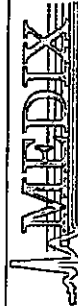

3008 MOBILE DRIVE  
 ELKHART, IN 46514  
 PH: 574-266-0911  
 SPECIALTY VEHICLES, INC. FAX: 574-266-6669

"LET US SHOW YOU THE MEDIX DIFFERENCE"  
 WWW.MEDIXAMBULANCE.COM

Sales Order # 271 Date August 8, 2025  
 Customer Account # 11006 Customer P.O. # \_\_\_\_\_



NAME East Erie County Emergency Management  
 ATTN. DJ Holman  
 ADDRESS 5601 Buffalo Rd  
 CITY Harbrcreek STATE PA ZIP 16421  
 PHONE 814-898-2299 FAX \_\_\_\_\_  
 E-MAIL ecsuprv@verizon.net

NAME \_\_\_\_\_  
 ATTN. \_\_\_\_\_  
 ADDRESS \_\_\_\_\_  
 CITY \_\_\_\_\_ STATE \_\_\_\_\_ ZIP \_\_\_\_\_  
 PHONE \_\_\_\_\_ FAX \_\_\_\_\_  
 E-MAIL \_\_\_\_\_

ITEM	QTY	MODEL #	DESCRIPTION	UNIT PRICE	EXT. PRICE
A	1	VM5830 (Dual Head EMS)	UHF-HI, DUAL REMOTE, KCH-19, MOBILE	\$3,940.08	\$3,940.08
B	1	499762	0-8000 MHz, Thick Mount, 17' RG58AVU, No Connector	\$61.24	\$61.24
C	1	49165	450 - 470 MHz Unity Gain 1/4 Wave Antenna with Stainless Finish	\$21.76	\$21.76
D	1	91538	UHF Male Crimp for RG58, RG141, and LMR@-200 Cable	\$5.69	\$5.69
E	1	VP5330 (Fire/EMS)	UHF (450-520 MHz), Model 2, Black <i>Includes KNB-L1 Battery, KSC-52AK Charger, and KMC-70M Speaker Mic</i>	\$3,374.28	\$3,374.28
INSTALLATION & SPECIAL INSTRUCTIONS				QUOTE IS VALID 14 DAYS	
PAYMENT TERMS					

**Summary of Terms and Conditions of Sale:**  
 All sales by Mobilecom are governed by Mobilecom's Terms and Conditions. Please refer to [www.mobilecom.net](http://www.mobilecom.net) for the complete Mobilecom Terms and Conditions. This sales order, in conjunction with the Mobilecom Terms and Conditions, constitutes the entire agreement between the parties, and all other terms, including those in any customer purchase order, are specifically rejected as a condition of sale. Limited Warranty: Exclusions and Disclaimers: Mobilecom warrants all equipment and installation services rendered against defects in materials and labor for a period of twelve (12) months (the "Warranty Period"). Expendable supplies, equipment and parts, or any portions of the equipment or installation which have been misused, abused, neglected, or damaged by an act of God are not covered by this limited warranty. Any defect in the equipment or installation during the Warranty Period will be repaired or replaced at the option of Mobilecom. Any shipping charges in connection with a repair or replacement shall be the responsibility of Customer. The repair or replacement of defective equipment or installation shall constitute Customer's sole remedy against Mobilecom. ANY AND ALL OTHER WARRANTIES, EXPRESSED OR IMPLIED, INCLUDING THE WARRANTIES OF MERCHANTABILITY OR FITNESS FOR A PARTICULAR PURPOSE, ARE DISCLAIMED. CONSEQUENTIAL OR EXEMPLARY DAMAGES AS A RESULT OF A DEFECT IN LABOR, EQUIPMENT OR OTHER SUPPLIES OR MATERIALS AND/OR SERVICES PROVIDED, OTHER THAN DAMAGES CAUSED BY MOBILECOM'S SOLE GROSS NEGLIGENCE. Customer specifically agrees that in no event shall Mobilecom's liability pursuant to any sale exceed the purchase price paid by Customer to Mobilecom for the specific defective equipment or installation.

EQUIPMENT	\$7,403.05
INSTALLATION	\$600.00
Program/Setup	\$30.00
OTHER	
SHIPPING	\$15.00
SUB-TOTAL	\$8,048.05
TAX	Exempt
First Year Warranty Support	
TOTAL	\$8,048.05
DOWN PAYMENT	
BALANCE DUE	\$8,048.05

CUSTOMER SIGNATURE \_\_\_\_\_  
 PHONE ORDER \_\_\_\_\_

Title

**East Erie County Emergency  
Medical Services Corporation  
(Dba: East County EMS)**

08/08/2025

id. 51315795

by Donald Holman in Erie County Fire/EMS  
Transformational Grant Program

ecsupv@verizon.net

**Original Submission**

08/08/2025

Score

Name of Organization/Agency Applying East Erie County Emergency Medical Services Corporation (Dba: East County EMS)

Primary Contact Donald Holman

Primary Contact Title Director

Primary Contact Email ecsupv@verizon.net

Primary Contact Phone +18148982299

Organization/Agency Mailing Address 5601 Buffalo Road  
Harborcreek  
PA  
16421  
US  
42.157362  
-79.9724751

Website (Optional) <https://www.facebook.com/EastCountyEMS/>

Employer Identification Number (EIN) 251633230

Total Amount Requested from the Transformational Grant Program 150000

Organization  
Description

The East Erie Emergency Medical Services Corporation was formed in 2019 in response to the growing need for paid emergency medical response due to the growing decline of of volunteer ambulance service providers in our area. Prior to the formation of our agency, volunteer fire departments frequently failed to respond to emergency medical calls, resulting in long wait times for patients as another ambulance had to be found to respond to their emergency, resulting in jeopardized patient outcomes due to these "dropped" calls being transferred to outside agencies, as well as creating uncertainty among the public when it came to emergency response.

In response to this crisis, the communities of Harborcreek, Lawrence Park, and Wesleyville each agreed to form the East Erie County Emergency Medical Services Corporation as a multi-municipal project after each participating municipality examined various ways of addressing the volunteer staffing crisis. Members of these municipalities comprise our Board of Directors, and are are responsible for decisions involving overall agency operation and finance. These member municipalities also provide limited financial support and other services to our agency, such as financial contributions and donated office space and other services. Under our model, we provide a paid, staffed Advanced Life Support unit 24/7/365 dispatched along with the existing volunteer fire department. In the event the volunteer agency fails to respond, our paid ambulance crew from our agency will continue to provide the care and interventions and transport the patient to the necessary medical facility, and thus bill the patient's insurance carrier to provide revenue to sustain our entity and provide for expansion.

Response and Recovery

Our proposed project is the addition of an additional transportable ambulance to handle increased needs for emergency service. Our goal is to have this vehicle staffed and in service immediately after receiving the vehicle and installing the necessary equipment and completing the necessary State Bureau of EMS inspection. Our objective is to purchase an "off the shelf" four wheel drive ambulance with power load cot system and little customization in order to receive the vehicle in a shorter time frame to meet our goal of having this unit "on the road" in late 2025 or early 2026.

The partners in this project are the municipalities of Lawrence Park, Wesleyville, Harborcreek, North East Borough and Township, and Greenfield Township. Their roles going forward are continued financial and logistical support, as well as serving on our Board of Directors. We envision future expansion with the cooperation and support of these municipalities of East County EMS being the sole provider of ambulance service in eastern Erie County.

Our project will positively transform the provision of emergency emergency services in East County by shortening response times to emergencies by having additional staffed units available for incidents, as well as allowing our agency to cover multiple incidents at the same time with a fully transportable unit, reducing the need for an outside agency to assist and negating the associated wait time that unit to arrive.

---

Critical Need

In January of 2025, North East Township and North East Borough designated East County as their primary Advanced Life Support provider, resulting in increase of calls for service from our agency, and also increased patient transports when the North East volunteer ambulance does not respond. Following the addition of North East, Greenfield Township designated East County EMS as it's ALS provider in May of 2025, also increasing our area and requests for service.

To this end, it has become necessary to schedule additional staff, as well as add an additional transportable ambulance to effectively respond to incidents in this increased area, as we are unable to handle multiple emergencies with the single transportable ambulance we currently operate. In the event this existing vehicle goes down for maintenance or repairs, we have to operate non-transportable fly cars, or attempt to borrow an ambulance from another service, which is not always feasible. When this occurs, we become reliant on volunteer services to respond, or wait for another service from further away to respond for the transport, which results in delays. It is our endeavor to have two fully staffed ALS transportable units in service to more effectively handle emergencies in these additional areas, as well as being able to more effectively handle emergency responses outside of our designated area, such as the City of Erie and surrounding areas while ensuring coverage to our "home" area.

---

Evaluation	The effectiveness of this project will be measurable by the examination of shortened response times, number of incidents responded to, and also the examination of final reports of patient health outcomes after being cared for by this agency. The reduction in response times should result in better patient health outcomes after times of medical emergency requiring emergent care.
Sustainability	The project will be financially sustained beyond the initial grant award in the form of municipal contributions from our member communities, as well as service revenue generated from patient care and transports from the billing of patients and their insurance carriers. Additionally, further grants may be pursued to add additional equipment and resources as necessary. It is our goal to not only add resources now, but further expand as the needs become more apparent and our communities become further reliant on East County when the volunteer system declines further.
Support Materials (Optional)	<a href="#">East_County_Grant_Supporting_Docs.pdf</a>
Budget	<a href="#">Project Budget Table_Transformational.xlsx</a>
Budget Narrative	The funding for the project are projected as follows: \$100,000 which has been previously awarded by ECGRA, and the potential award of \$150,000 from this grant opportunity. The vehicle itself will cost \$242,688.20, and purchase and installation of necessary radio equipment of \$8,048.05 (County vehicle mounted radio and portable radio). Additional funding will be from East County EMS revenue for radio costs.
Certification	checked
Name of Person Certifying the Application	Donald L. Holman



# COUNTY OF ERIE

OFFICE OF THE COUNTY EXECUTIVE

Brenton Davis,  
County Executive

## CERTIFICATE OF THE COUNTY EXECUTIVE

RE: 2025 General Fund Budget

It is hereby *Certified*, pursuant to Article VIII, Section 8 of the Erie County Home Rule Charter, that there are funds available for Appropriation of \$150,000 for East County EMS Grant to Purchase an Ambulance.

A handwritten signature in black ink, appearing to read "B. Davis", written over a horizontal dashed line.

Brenton Davis,  
Erie County Executive  
Erie County, Pennsylvania

August 28, 2025

ljk